

LibreOffice
The Document Foundation

Calc Guide

Preface

Copyright

This document is Copyright © 2012 by its contributors as listed below. You may distribute it and/or modify it under the terms of either the GNU General Public License (<http://www.gnu.org/licenses/gpl.html>), version 3 or later, or the Creative Commons Attribution License (<http://creativecommons.org/licenses/by/3.0/>), version 3.0 or later.

All trademarks within this guide belong to their legitimate owners.

Contributors

Jean Hollis Weber

Feedback

Please direct any comments or suggestions about this document to:
documentation@global.libreoffice.org

Publication date and software version

Published 30 June 2012. Based on LibreOffice 3.4.6.

Contents

Copyright.....	2
Who is this book for?.....	4
What's in this book?.....	4
Where to get more help.....	4
Help system.....	4
Free online support.....	4
Paid support and training.....	5
What you see may be different.....	5
Using LibreOffice on a Mac.....	5
What are all these things called?.....	6
Who wrote this book?.....	7
Acknowledgements.....	7
Frequently asked questions.....	7

Who is this book for?

Anyone who wants to get up to speed quickly with LibreOffice Calc will find this book valuable. You may be new to office software, or you may be familiar with another office suite.

What's in this book?

This book introduces Calc, the spreadsheet component of LibreOffice. You can enter data (usually numerical) in a spreadsheet and then manipulate this data to produce certain results.

Alternatively, you can enter data and then use Calc in a 'What if...' manner by changing some of the data and observing the results without having to retype the entire spreadsheet or sheet.

Other features provided by Calc include:

- Functions, which can be used to create formulas to perform complex calculations on data.
- Database functions, to arrange, store, and filter data.
- Dynamic charts; a wide range of 2D and 3D charts.
- Macros, for recording and executing repetitive tasks; scripting languages supported include LibreOffice Basic, Python, BeanShell, and JavaScript.
- Ability to open, edit, and save Microsoft Excel spreadsheets.
- Import and export of spreadsheets in multiple formats, including HTML, CSV, PDF, and PostScript.

Where to get more help

This book, the other LibreOffice user guides, the built-in Help system, and user support systems assume that you are familiar with your computer and basic functions such as starting a program, opening and saving files.

Help system

LibreOffice comes with an extensive Help system. This is your first line of support for using LibreOffice.

To display the full Help system, press *F1* or select **LibreOffice Help** from the Help menu. In addition, you can choose whether to activate Tips, Extended tips, and the Help Agent (using **Tools > Options > LibreOffice > General**).

If Tips are enabled, place the mouse pointer over any of the icons to see a small box ("tooltip") with a brief explanation of the icon's function. For a more detailed explanation, select **Help > What's This?** and hold the pointer over the icon.

Free online support

The LibreOffice community not only develops software, but provides free, volunteer-based support. See Table 1 and this web page: <http://www.libreoffice.org/get-help/>

Users can get comprehensive online support from the community through mailing lists. Other websites run by users also offer free tips and tutorials. This forum provides community support for LibreOffice and other programs: <http://user.services.openoffice.org/en/forum/>

Paid support and training

Alternatively, you can pay for support services. Service contracts can be purchased from a vendor or consulting firm specializing in LibreOffice.

Table 1: Free support for LibreOffice users

Free LibreOffice support	
FAQs	Answers to frequently asked questions http://www.libreoffice.org/get-help/faq/ http://wiki.documentfoundation.org/Faq
Documentation	User guides, how-tos, and other documentation. http://www.libreoffice.org/get-help/documentation/ https://wiki.documentfoundation.org/Documentation/Publications
Mailing lists	Free community support is provided by a network of experienced users http://www.libreoffice.org/get-help/mailling-lists/
International support	The LibreOffice website in your language. http://www.libreoffice.org/international-sites/ International mailing lists http://wiki.documentfoundation.org/Local_Mailing_Lists
Accessibility options	Information about available accessibility options. http://www.libreoffice.org/get-help/accessibility/

What you see may be different

LibreOffice runs on Windows, Linux, and Mac OS X operating systems, each of which has several versions and can be customized by users (fonts, colors, themes, window managers).

The pictures in this book were taken from a variety of computers and operating systems. Some pictures will therefore not look exactly like what you see on your computer.

Using LibreOffice on a Mac

Some keystrokes and menu items are different on a Mac from those used in Windows and Linux. The table below gives some common substitutions for the instructions in this chapter. For a more detailed list, see the application Help.

Windows or Linux	Mac equivalent	Effect
Tools > Options menu selection	LibreOffice > Preferences	Access setup options
<i>Right-click</i>	<i>Control+click</i>	Open a context menu
<i>Ctrl (Control)</i>	<i>⌘ (Command)</i>	Used with other keys
<i>F5</i>	<i>Shift+⌘+F5</i>	Open the Navigator
<i>F11</i>	<i>⌘+T</i>	Open the Styles and Formatting window

What are all these things called?

The terms used in LibreOffice for most parts of the *user interface* (the parts of the program you see and use, in contrast to the behind-the-scenes code that actually makes it work) are the same as for most other programs.

A *dialog* is a special type of window. Its purpose is to inform you of something, or request input from you, or both. It provides controls for you to use to specify how to carry out an action. The technical names for common controls are shown in Figure 1; not shown is the list box (from which you select an item). In most cases we do not use the technical terms in this book, but it is useful to know them because the Help and other sources of information often use them.

In most cases, you can interact only with the dialog (not the document itself) as long as the dialog remains open. When you close the dialog after use (usually, clicking **OK** or another button saves your changes and closes the dialog), then you can again work with your document.

Some dialogs can be left open as you work, so you can switch back and forth between the dialog and your document. An example of this type is the Find & Replace dialog.

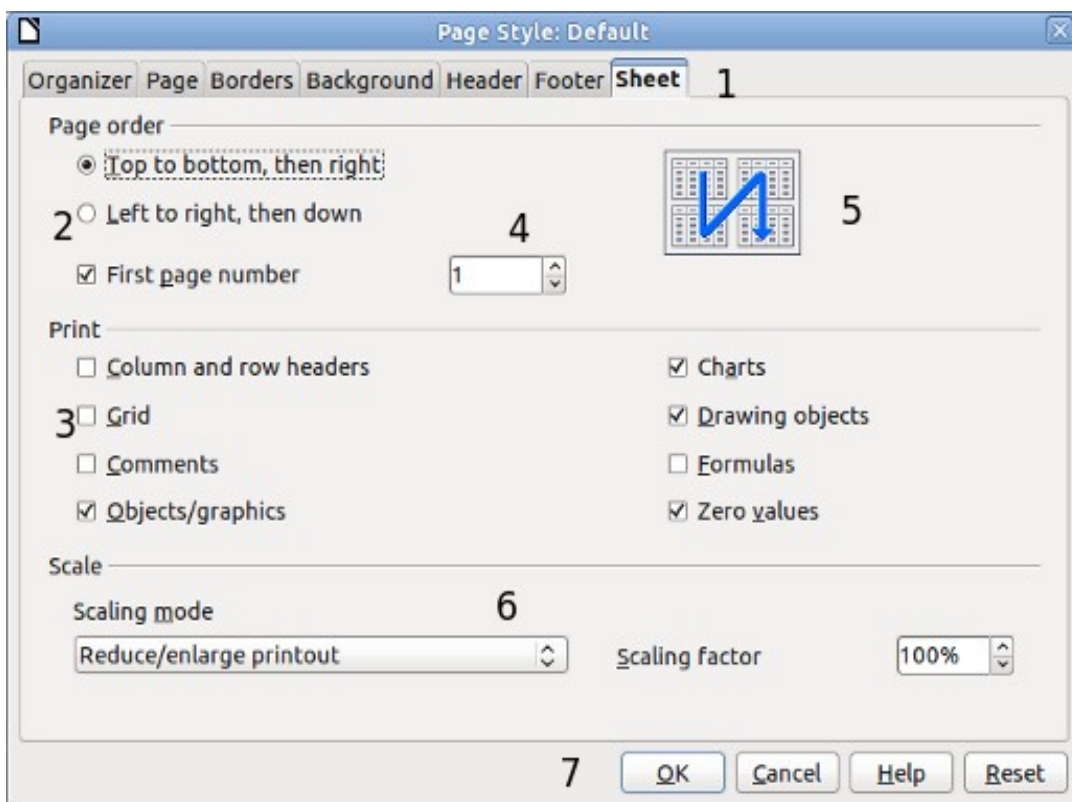

Figure 1: Dialog showing common controls:

- 1 = Tabbed page (not strictly speaking a control)
- 2 = Radio buttons (only one can be selected at a time)
- 3 = Checkbox (more than one can be selected at a time)
- 4 = Spin box (click the up and down arrows to change the number shown in the text box next to it, or type in the text box)
- 5 = Thumbnail or preview
- 6 = Drop-down list from which to select an item
- 7 = Push buttons

Who wrote this book?

This book was written by volunteers from the LibreOffice community. Profits from sales of the printed edition will be used to benefit the community.

Acknowledgements

This book is adapted from *OpenOffice.org 3.3 Calc Guide*. The contributors to that book are:

Rick Barnes	Peter Kupfer	Martin Fox
James Andrew	Krishna Aradhi	Andy Brown
Stephen Buck	Bruce Byfield	Nicole Cairns
T. J. Frazier	Stigant Fyrwitful	Ingrid Halama
Spencer E. Harpe	Regina Henschel	Peter Hillier-Brook
John Kane	Kirk Abbott	Emma Kirsopp
Jared Kobos	Sigrid Kronenberger	Shelagh Manton
Alexandre Martins	Kashmira Patel	Anthony Petrillo
Andrew Pitonyak	Iain Roberts	Hazel Russman
Gary Schnabl	Rob Scott	Jacob Starr
Sowbhagya Sundaresan	Nikita Telang	Barbara M Tobias
John Viestenz	Jean Hollis Weber	Stefan Weigel
Sharon Whiston	Claire Wood	Linda Worthington
Michele Zarri	Magnus Adielsson	Sandeep Samuel Medikonda

Frequently asked questions

How is LibreOffice licensed?

LibreOffice is distributed under the Open Source Initiative (OSI) approved Lesser General Public License (LGPL). The LGPL license is available from the LibreOffice website:

<http://www.libreoffice.org/download/license/>

May I distribute LibreOffice to anyone?

Yes.

How many computers may I install it on?

As many as you like.

May I sell it?

Yes.

May I use LibreOffice in my business?

Yes.

May I distribute the PDF of this book, or print and sell copies?

Yes, as long as you meet the requirements of one of the licenses in the copyright statement at the beginning of this book. You do not have to request special permission. In addition, we request that you share with the project some of the profits you make from sales of books, in consideration of all the work we have put into producing them.

How can I contribute to LibreOffice?

You can help with the development and user support of LibreOffice in many ways, and you do not need to be a programmer. For example, you can help with producing and maintaining written user documentation, producing video tutorials, and other user support services. To start, check out this webpage: <http://www.documentfoundation.org/contribution/>